

# ARU-M

## ANSI Reversible Strike

### Range: Electric Strikes

The ARU series of ANSI strikes offer fail-secure or fail-safe in one unit. Suitable for wooden or metal doors, these strikes are robust with a stainless steel jaw for added strength.

The design and high resistance to vandalism make it suitable to secure residential as well as industrial sites.

With monitoring as standard and supplied complete with long and short faceplates and a full fixing kit for metal doors, the ARU series is truly a universal strike.

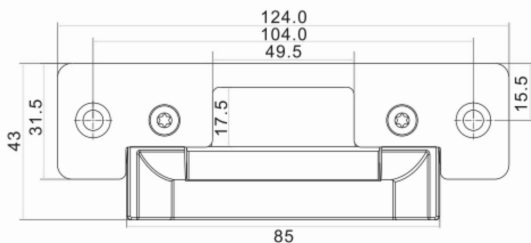

ARUM C/W SHORT FACEPLATE

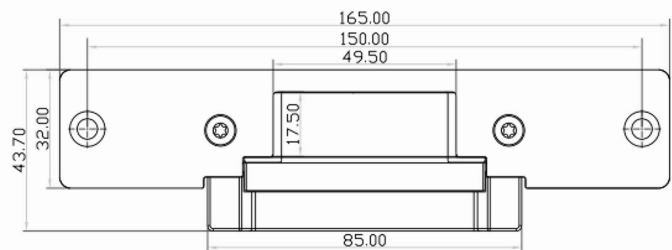

ARUM C/W LONG FACEPLATE

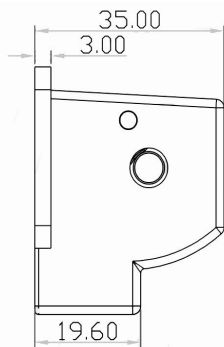

SIDE PROFILE DIMENSIONS

### Key features

- Monitored as standard
- ANSI Style
- Stainless steel jaw
- Reversible - fail secure/fail safe
- Long & short faceplate included

### Technical specifications

- **Dimensions (L x W x D):**
  - Lock body (incl. lip) 85 x 35 x 44mm
  - Short faceplate 124 x 32 x 3mm
  - Long faceplate 165 x 32 x 3mm
- **Operating temperature:**
  - 25°C to +70°C
- **Operating voltage:**
  - 12Vdc
- **Operating current:**
  - 250mA nominal
- **Jaw Pull Strength:**
  - 1000kg