

Order Code	RFID Type	Suitability
ACTpro eLock	125 KHz	No key override or privacy latch facility
ACTpro eLock K	125 KHz	Key override facility only
ACTpro eLock P	125 KHz	privacy latch facility only
ACTpro eLock K2	125 KHz	Key override and privacy latch facility
ACTpro eLock MF	MIFARE	No key override or privacy latch facility
ACTpro eLock MFK	MIFARE	Key override facility only
ACTpro eLock MFP	MIFARE	Privacy latch facility only
ACTpro eLock MFK2	MIFARE	Key override and privacy latch facility

**Please Note:** Cylinders or privacy latches are not included. The escutcheon plates are blank in the case of “no key override” or have euro profile slots to facilitate the cylinder and or privacy latch.

**Fire Rating Standard**

BS EN 1634-1:2014 - 30 and 60 minute fire doors

**Door Furniture Test Standard**

BS EN 1906:2013 Grade 3 (37-B010)

ACTpro eLock Hub Controller and Accessories

Order Code	Product Description
ACTpro eLock hub	Wireless hub controller for up to 32 eLocks
ACTpro eLock TST	Battery operated test unit for range testing
ACTpro eLock MC	Memory card for expanded feature set
ACTpro eLock DM	Door monitor contact
ACTpro eLock BAT	CR123A lithium battery for eLock (one required per lock)

ACTenterprise Software

Order Code	Product Description
ACTEnt	ACTpro Enterprise Software (multiple administrator PC's)
ACTEnt Lite	ACTpro Enterprise Software (single administrator PC)

Dimensions & Technical Information

Specifications	eLock	Hub
Ethernet Connection	N/A	TCP/IP 100Mbit/s DHCP or static IP address
Operating Voltage	1 X 3Volt lithium battery (CR123A)	12VDC or POE (802.3 af)
Weight	1.3Kg	450gms
Operating Temperature	Zero to +50 degrees Celsius	Zero to +50 degrees Celsius
Dimensions (HxWxD mm)	293x46x30 inside 293x46x25 outside	165x236x55
Lock casing	Euro profile (8mm spindle)	Not Supplied

ACTpro eLock

Real time wireless networked electronic locks that can be installed within minutes on most internal wooden door types. Up to 32 locks can communicate over a wireless network with each ACTpro eLock hub.

The hub is compatible with the ACTpro 4000 and 1500 series door controllers. System configuration and administration is facilitated via ACT Enterprise PC software.

2 Year Warranty on eLock systems

Lock Features

- Up to 200,000 lock activations (CR123A Lithium battery)
- Hi-secure 128bit AES encrypted wireless communication (868MHz)
- Up to 100m range (locks to hub receiver)
- Auto discovery of locks for ease of set up
- Memory card for extra door rights
- Fire Alarm override and toggle modes
- White listed cards (Master Key access always)
- Battery voltage monitoring (at lock and PC)
- USB interface provides external power in the event of battery failure
- Door/tamper monitoring (magnetic contact required)
- Suitable for internal wooden doors (36 - 60mm wide)
- Requires Euro profile lock casing (8 mm spindle)
- Brushed stainless steel finish
- Free egress at all times via inside handle



# ACTpro eLock

## Hub Features

- 32 eLocks per hub (up to 100m range)
- 60,000 users
- Connects to Enterprise software over TCP/IP connection
- Signal strength monitoring
- Auto discovery of locks
- Timed actions
- POE or 12V DC supply
- Compatible with ACTpro controllers

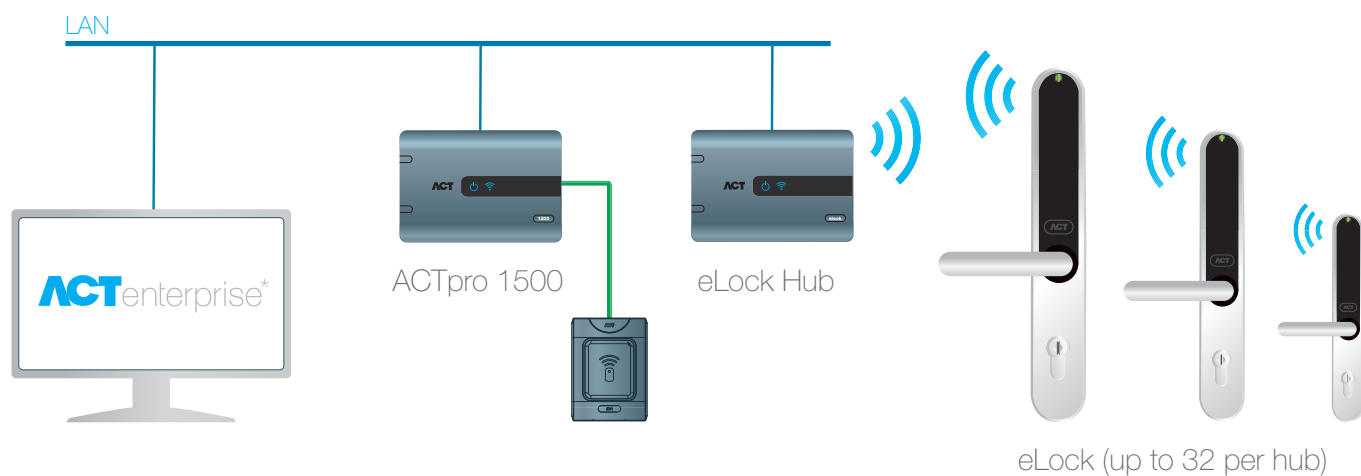

ACT supply a wireless range test kit  
**Order Code:** ACTpro elock tst



## OUTSIDE

## INSIDE

## MODELS

### ACTpro eLock

No Key Override  
No Privacy Latch

#### Order Codes

125Khz	ACTpro eLock
MIFARE	ACTpro eLock MF

### ACTpro eLock K

Key Override  
No Privacy Latch

#### Order Codes

125Khz	ACTpro eLock K
MIFARE	ACTpro eLock MFK

### ACTpro eLock P

No Key Override  
Privacy Latch

#### Order Codes

125Khz	ACTpro eLock P
MIFARE	ACTpro eLock MFP

### ACTpro eLock K2

Key Override  
Privacy Latch

#### Order Codes

125Khz	ACTpro eLock K2
MIFARE	ACTpro eLock MFK2

**PLEASE NOTE:** Cylinders and latches are not supplied by ACT and ACT Enterprise software must be used to configure and administrate the hubs and locks.